

Part No:

29J-2H-625-012

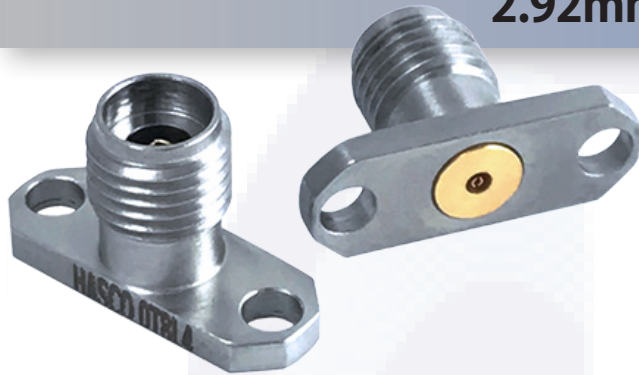

2.92mm Female Connector with .625" 2-Hole Flange • DC - 40 GHz



The HASCO **29J-2H-625-12** is a 2.92mm Female Connector with .625" 2-hole flange. It operates from DC to 40 GHz and has a VSWR or 1.25:1 DC to 40Ghz.

HASCO stocks an extensive selection of RF and Microwave connectors. Including Precision Super SMA, 3.5mm, 2.92mm, 2.40mm, 1.85mm, Type N, TNC, End Launch and cable connectors.

Electrical

• Frequency Range	DC-40 GHz
• VSWR	1.25 MAX
• Impedence	50 Ohms
• Insertion Loss	.05 $\sqrt{\text{Frequency}}$
• Temperature Rating	-55°C to +100°C

Material

• Housing	Passivated Stainless Steel per ASTM A484 and A582
• Contact	Beryllium Copper (BeCu) per ASTM-B-196, QQ-C-530
• Center Contact and Solder Components	Plated per MIL-G-45204 Type II, Class I over Nickel plate per QQ-N-290
• Dielectric	Oxide-Noryl™

To view online, go to: <https://www.hasco-inc.com/connectors/2-92mm-connectors/2-92mm-female-connector-2-hole-625-long-flange-accepts-012-pin-dia-dc-to-40-ghz/>