

MODEL No.:

26359-001J

NOTE: Information herein is believed by Southwest Microwave, Inc. to be accurate. However, Southwest Microwave assumes no responsibility for any omissions or errors or inaccuracies for its use or for any infringements of patents or other rights of third parties that may result from its use. Data is intended for informational purpose only and does not constitute a contract of sale or any express or implied warranty, including any warranty of merchant ability or fitness for a particular purpose.

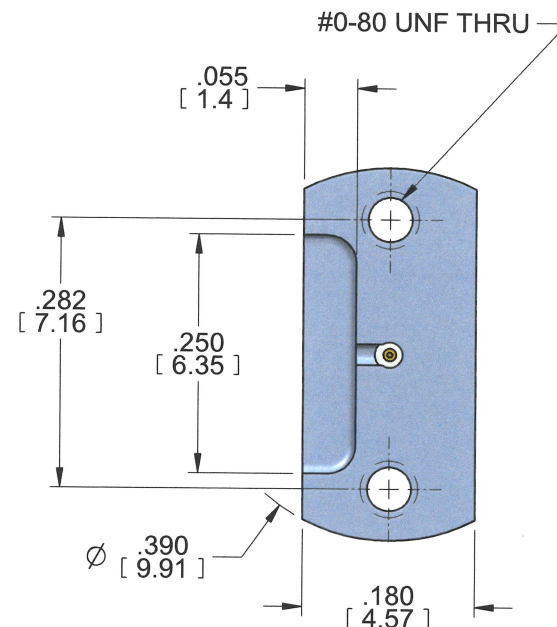
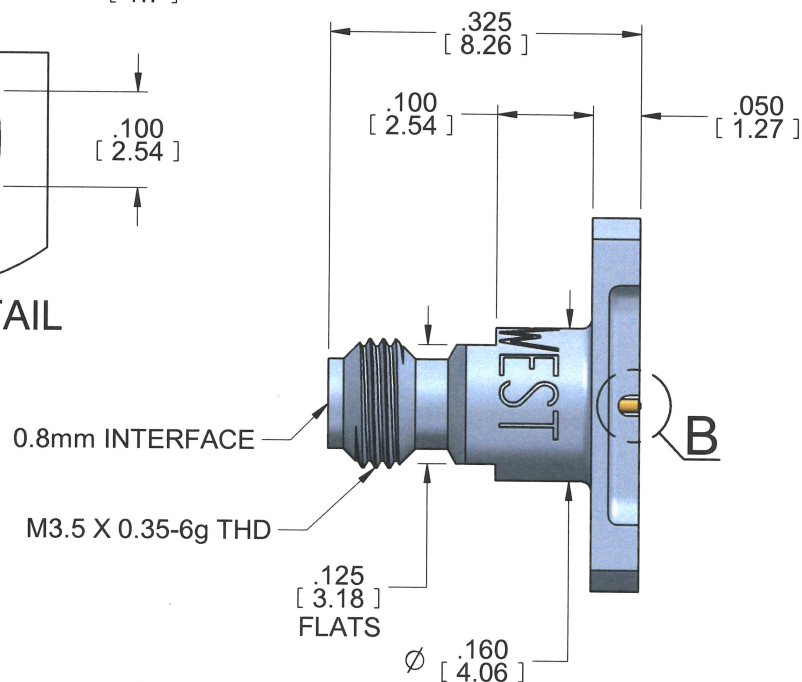
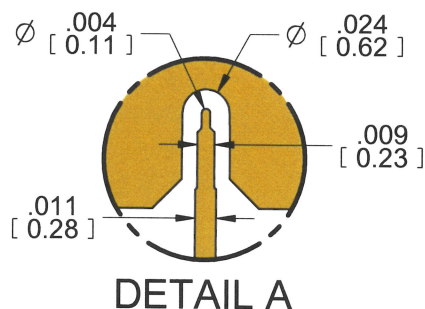
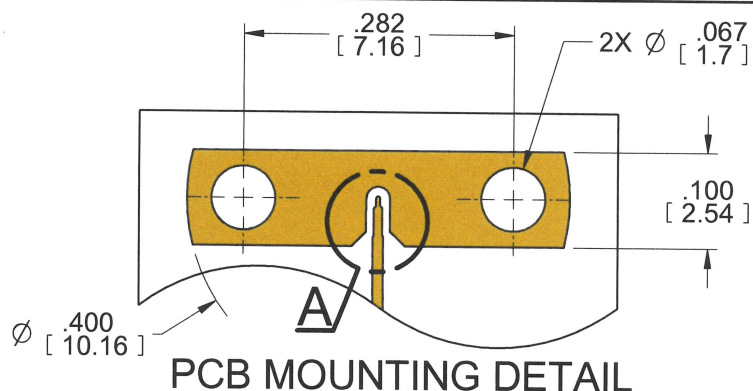

HOUSING:	STEEL, CRES ALLOY UNS-30300 PER ASTM A582 PASSIVATED PER ASTM A967
CONTACT:	BeCu UNS-C17300 PER ASTM B196/197 GOLD PLATE PER ASTM B488
CAPTURE BEAD:	KEL-F (PCTFE) PER ASTM D 1430
ITEM	MATERIAL & FINISH

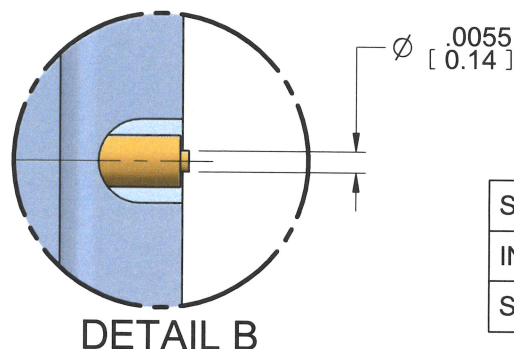

SPECIFICATIONS	TBD
INTERFACE	TBD (IEEE 287.1)
SPECIFICATION GROUP	DRAWING NO.

1. ALL DIMENSIONS ARE IN INCHES. ALL ANGLES ARE IN DEGREES. DIMENSIONS SHOWN IN BRACKETS [XXX] ARE IN MILLIMETERS.

NOTES: UNLESS OTHERWISE SPECIFIED.

REV
X1

RELEASE

APRVD.

DATE:

3/18/2016

TITLE

26359-001J

0.8mm JACK 2 HOLE VERTICAL LAUNCH
FOR MICROSTRIP OR GCPWG



Southwest Microwave, Inc.
9055 South McKemy Street
Tempe, Arizona 85284-2946
Telephone (480) 783-0201
Fax (480) 783-0360

DRN BY:
JACDATE:
08/20/24

DWG. NO.

SCALE: 5:1

SHEET: 1 OF 1

79DD70497

REV.

X1